

Interruttore bipolare a bascula / Double Pole Rocker switch

Temperatura/ Temperature: T 55/120° C

Fissaggio/ Fixing: Snap-in

Contatti/ Contacts: argento/silver

Terminali/ Terminals: ottone argentato 6,35x0,8/tabs silver plated brass (.250)

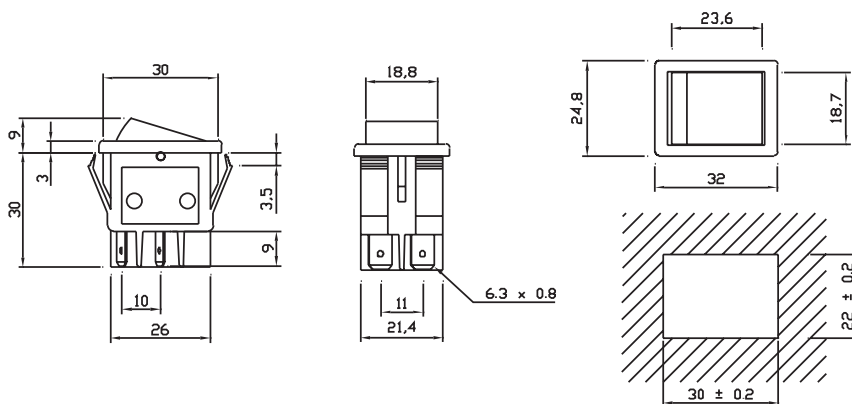

CODICE Code	FUNZIONE Function	SCHEMA ELETTRICO Circuit Diagram	DESCRIZIONE Description
401.1	ON-OFF		Interruttore a bascula bipolare non luminoso Double pole unlighted rocker switch
401.1.IST	ON-OFF (mom)		Interruttore Bipolare Istantaneo Double Pole Momentary
401.1.DEV	ON-ON		Deviatore bipolare Double Pole Changeover
401.1.DEV.IST	ON-ON (mom)		Deviatore bipolare Istantaneo Changeover - Momentary
401.L	ON-OFF		Interruttore Bipolare Luminoso Double Pole Lighted Rocker Switch
401.L.IST	ON-OFF (mom)		Interruttore Bipolare Istantaneo Luminoso Momentary - Lighted
401.L.DEV.IST	ON-ON (mom)		Deviatore Istantaneo Luminoso Changeover Momentary

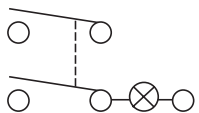
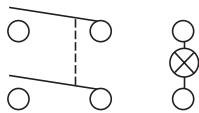
401.L.IND.5	ON-OFF		Interruttore bipolare luminoso con lampada indipendente <i>Double pole switch with independent lamp</i>
401.L.IND.6	ON-OFF		Interruttore bipolare luminoso con lampada indipendente <i>Double pole switch with independent lamp</i>
.....	Schema elettrico a richiesta <i>Circuit diagram on request</i>

Segnalatore Luminoso/ Signal Lamp

Temperatura/ Temperature: T 55/120° C

Fissaggio/ Fixing: Snap-in

Contatti/ Contacts: ottone/brass

Terminali/ Terminals: ottone/brass

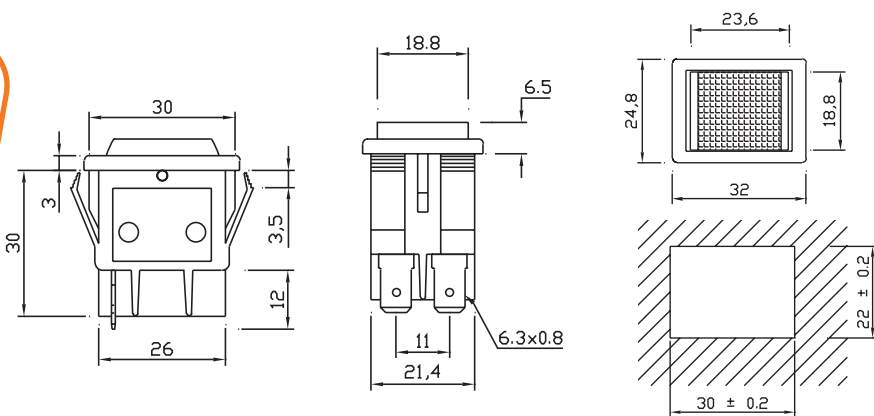

CODICE
Code

SCHEMA ELETTRICO
Circuit Diagram

DESCRIZIONE
Description

401.S.



Segnalatore luminoso
Signal lamp

Colori standard di serie / Regular standard colours

Tasto/Rocker

Gemma/Rocker



Cornice/Frame



Colori speciali solo per grandi quantitativi - Special colours only for large quantities

Serigrafie - Symbols

A 11	A 12	A 13	A 14	A 15	A 16	A 17	A 18	A 19	A 21
								B R E W	
A 22	A 23	A 24	A 28	A 34	A 35	A 36	A 43	A 44	A 45
			OFF ON						
A 47	A 53	A 54	A 55	A 56	A 57	A 58	A 59	A 60	A 61
					HD	ND	MS	WP	BR
A 62	A 63	A 77	A 78	A 79	B 01	B 03	B 04	B 09	B 10
AT	FS				0 1	- =	I II		
B 12	B 13	B 14	B 15	B 16	B 17	B 18	B 19	B 20	B 21
							OFF ON	LAMPS	LIGHT
B 23	B 25	B 27	B 28	B 29	B 30	B 31	B 34	B 36	B 37
ALARM	MANUAL								
B 38	B 40	B 41	B 43	B 47	B 51	B 53	B 56	B 63	B 64
		ON OFF	ON OFF						
B 65	B 66	B 67	B 69	B 84	B 85	B 87	B 96	B 97	B 98
			PUSH TO RESET			1 0 OFF ON			
B 100	B 122	B 123	B 126	B 136					
STOP	TROCKEN FEUCHT	+ -							

Interruttore bipolare a bascula / Double Pole Rocker switch

Temperatura/ Temperature: T 55/120° C

Fissaggio/ Fixing: Snap-in

Contatti/ Contacts: argento/silver

Terminali/ Terminals: ottone argentato 6,35x0,8/tabs silver plated brass (.250)

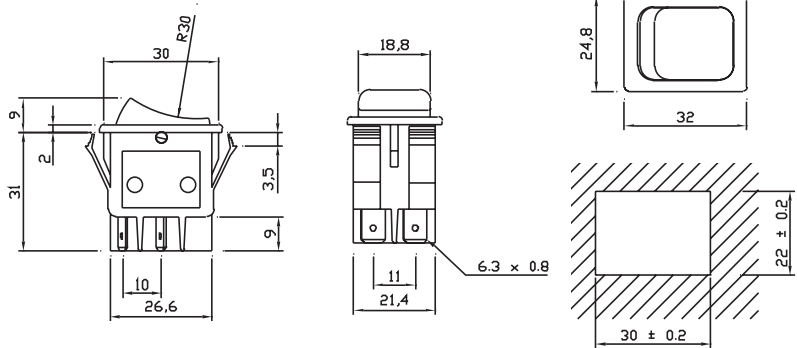

CODICE Code	FUNZIONE Function	SCHEMA ELETTRICO Circuit Diagram	DESCRIZIONE Description
0401.1	ON-OFF		Interruttore a bascula bipolare non luminoso Double pole unlighted rocker switch
0401.1.IST	ON-OFF (mom)		Bipolare Istantaneo Double Pole Momentary
0401.1.DEV	ON-ON		Deviatore bipolare Double Pole Changeover
0401.1.DEV.IST	ON-ON (mom)		Deviatore - Istantaneo Changeover - Momentary
0401.L	ON-OFF		Bipolare Luminoso Double Pole Lighted Rocker Switch
0401.L..F	ON-OFF		Bipolare Luminoso "LED" Double Pole Lighted with (point-led) on rocker
0401.L.IST	ON-OFF (mom)		Bipolare Istantaneo Luminoso Momentary - Lighted
0401.L.DEV.IST	ON-ON (mom)		Deviatore (Istantaneo) Changeover (Momentary)

0401.BIC.	ON-OFF		Interruttore bipolare non luminoso con bandella colorata <i>Double pole unlighted switch</i>
0401.C1	ON-OFF-ON (mom)		Commutatore bipolare con una posizione instabile <i>Double pole commutator with center off</i>
0401.C2	ON-OFF-ON (mom)-(mom)		Commutatore instabile <i>Double pole commutator with center off</i>
0401.C3	ON-OFF-ON		Commutatore stabile <i>Double pole commutator with center off</i>
0401.L.IND.5	ON-OFF		Interruttore bipolare luminoso con lampada indipendente <i>Double pole switch with independent lamp</i>
0401.L.IND.6	ON-OFF		Interruttore bipolare luminoso con lampada indipendente <i>Double pole switch with independent lamp</i>

Segnalatore Luminoso / Signal Lamp

Temperatura/ Temperature: T 55/120° C

Fissaggio/ Fixing: Snap-in

Contatti/ Contacts: ottone/brass

Terminali/ Terminals: ottone/brass

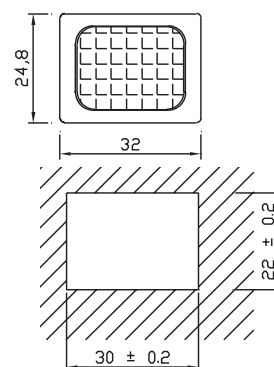
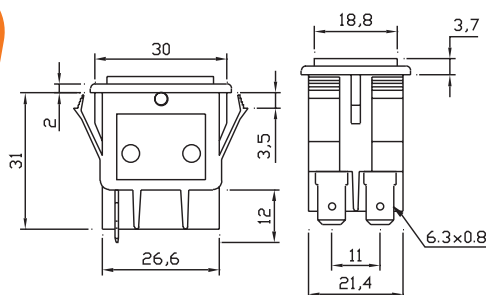

CODICE
Code

SCHEMA ELETTRICO
Circuit Diagram

DESCRIZIONE
Description

0401.S



Segnalatore luminoso
Signal lamp

Colori standard di serie / Regular standard colours

Tasto/Rocker Gemma/Rocker 









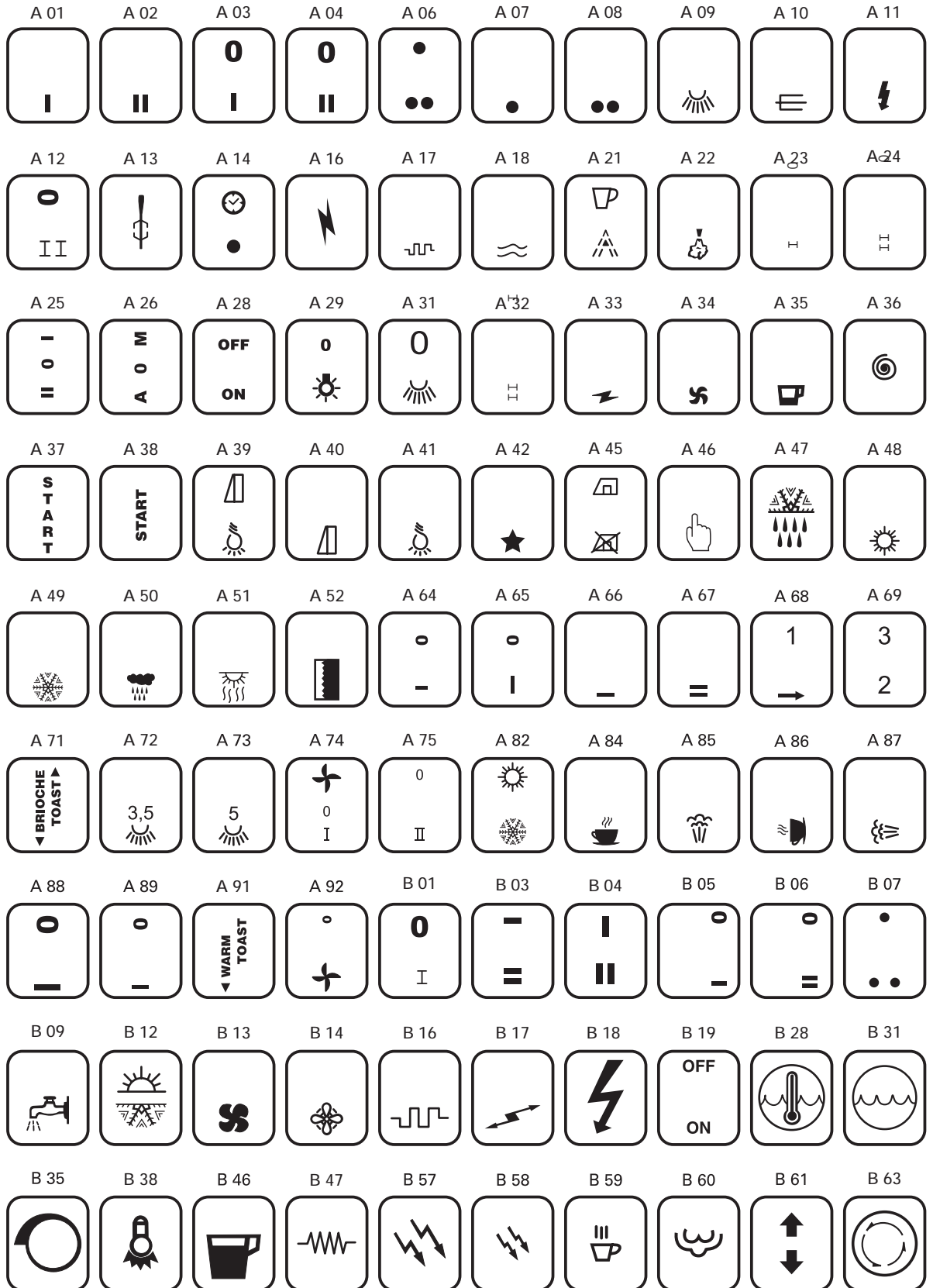









Cornice/Frame 

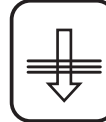

Colori speciali solo per grandi quantitativi - Special colours only for large quantities

Serigrafie - Symbols



B 64	B 65	B 66	B 69	B 74	B 75	B 76	B 78	B 79	B 80
			PUSH TO RESET			1 0	OFF ON		
B 81	B 82	B 84	B 88	B 89	B 90	B 91	B 93	B 94	B 95
3 5	NORMAL o AUTOMATIC		1 	2 	3 	4 	600 1200	1200 600	I O R
B 99	B 101	B 102	B 104	B 113	B 116	B 118	B 120	B 124	B 125
2000 750 1400	UP DOWN	NH3	MANUAL AUTOMATIC					ON OFF	
B 127	B 128	B 134	B 135	B 137	B 138	B 139	B 140		
H L	ATTESA MARCIA	TC	0 	ON OFF ON	OFF	ON	O I		

Interruttore bipolare a bascula / Double Pole Rocker switch

Temperatura/ Temperature: T 55/120° C

Fissaggio/ Fixing: Snap-in

Contatti/ Contacts: argento/silver

Terminali/ Terminals: ottone argentato 6,35x0,8/tabs silver plated brass (.250)

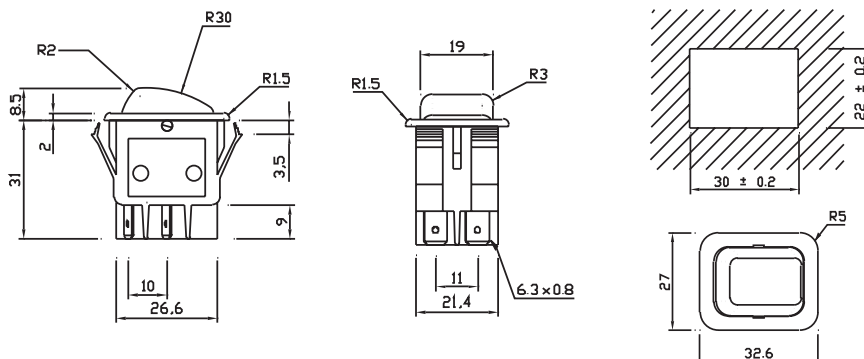

CODICE Code	FUNZIONE Function	SCHEMA ELETTRICO Circuit Diagram	DESCRIZIONE Description
00401.1	ON-OFF		Interruttore a bascula bipolare non luminoso Double pole unlighted rocker switch
00401.1.IST	ON-OFF (mom)		Bipolare Istantaneo Double Pole Momentary
00401.1.DEV.	ON-ON		Deviatore bipolare Double Pole Changeover
00401.1.DEV.IST	ON-ON (mom)		Deviatore - Istantaneo Changeover - Momentary
00401.L	ON-OFF		Bipolare Luminoso Double Pole Lighted Rocker Switch
00401.L.IST	ON-OFF (mom)		Bipolare Istantaneo Luminoso Momentary - Lighted
00401.L.DEV.IST	ON-ON (mom)		Deviatore (Istantaneo) Changeover (Momentary)

00401.C1	ON-OFF-ON (mom)		Commutatore bipolare con una posizione instabile <i>Double pole commutator with center off</i>
00401.C2	ON-OFF-ON (mom)-(mom)		Commutatore instabile <i>Double pole commutator with center off</i>
00401.C3	ON-OFF-ON		Commutatore stabile <i>Double pole commutator with center off</i>

Segnalatore Luminoso / Signal Lamp

Temperatura/ Temperature: T 55/120° C

Fissaggio/ Fixing: Snap-in

Contatti/ Contacts: ottone/brass

Terminali/ Terminals: ottone/brass

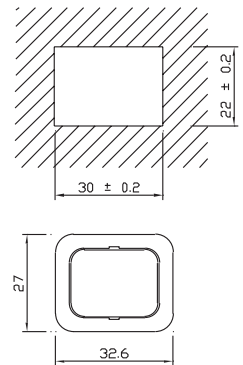
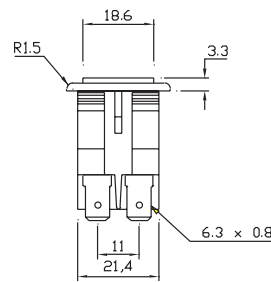
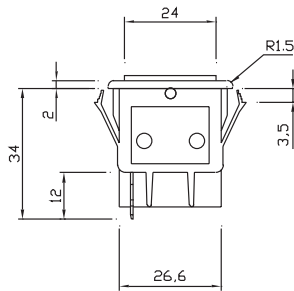

CODICE
Code

SCHEMA ELETTRICO
Circuit Diagram

DESCRIZIONE
Description

00401.S

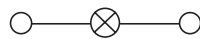

Segnalatore luminoso
Signal lamp

Colori standard di serie / Regular standard colours

Tasto/Rocker Gemma/Rocker



Cornice/Frame



Colori speciali solo per grandi quantitativi - Special colours only for large quantities

Serigrafie - Symbols

